



**The Sealed Battery Specialists**



Advanced American Technology and the use of the most modern computer-aided design and manufacturing techniques combine to make MK Battery's Sealed Gel Batteries the standard by which all other batteries are measured.



# GEL SPECIFICATIONS

## GENERAL APPLICATIONS

Specifications							Minutes Discharged @*						Discharge Amps to 1.75 VPC @ 77°F (25°C)*												Ampere Hour Capacity*						Weight	Dimensions - In (mm)							
Model	Foot Notes	Terminal Standard	Terminal Option	CCA @ 0° F	CA @ 32° F	Res.Capacity @ 80° F	75 Amps	50 Amps	25 Amps	15 Amps	8 Amps	5 Amps	5 Min	10 Min	15 Min	20 Min	30 Min	60 Min	90 Min	3 Hour	5 Hour	6 Hour	8 Hour	10 Hour	20 Hour	24 Hour	48 Hour	100 Hour	100 Hr Rate	20 Hr Rate	10 Hr Rate	6 Hr Rate	5 Hr Rate	3 Hr Rate	1 Hr Rate	Approx. Lbs. (Kgs.)	Length	Width	Total Height (Incl. Term.)
8GU1	P	T873	N/A	175	250	44	5	12	47	90	190	325	74.7	54.3	44.6	38.8	31.9	21.0	15.0	8.5	5.36	4.67	3.56	3.05	1.58	1.33	0.73	0.36	36.5	31.6	30.5	28.0	26.8	25.5	21.0	23.4 (10.6)	7 1/4 (197)	5 1/2 (130)	7 1/4 (184)
8GU1H	HP	T873	N/A	175	250	44	5	12	47	90	190	325	74.7	54.3	44.6	38.8	31.9	21.0	15.0	8.5	5.36	4.67	3.56	3.05	1.58	1.33	0.73	0.36	36.5	31.6	30.5	28.0	26.8	25.5	21.0	23.4 (10.6)	8 5/8 (211)	5 1/2 (130)	7 1/4 (184)
8G40	P	FEMALE 1/4"	N/A	225	325	59	11	21	63	120	250	430	110	79	61	51	39.8	25.8	19	10.63	6.8	-	-	3.7	2	1.7	0.92	0.48	48.0	40.0	37.0	35.0	34.0	31.9	25.8	31.7 (14.4)	7 1/4 (197)	6 5/8 (168)	6 7/8 (175)
8G22NF	PV	T881	N/A	210	300	77	13	27	82	157	330	557	120	86.7	69.1	60	47	31.8	23.2	13.3	8.64	7.65	5.74	4.75	2.55	2.15	1.16	0.58	58.2	50.9	47.5	45.9	43.2	39.9	31.8	37.0 (16.8)	9 3/8 (238)	5 1/2 (140)	9 1/4 (235)
8G34	P	FEMALE 1/4"	N/A	300	420	90	21	39	96	172	368	640	155	115	92	77	59	36	26	14.5	9.5	-	-	5.3	3	2.57	1.4	0.7	70.0	60.0	53.0	48.9	47.4	43.4	36.0	41.5 (18.8)	10 1/8 (259)	6 5/8 (169)	7 (178)
8G24	HPQ	T872M	N/A	410	575	132	35	57	140	245	500	845	215	160	125	105	80	48.5	35.0	19.77	12.6	10.75	8.30	6.8	3.68	3.12	1.68	0.845	84.5	73.6	68.0	64.5	63.0	59.3	48.5	52.5 (23.8)	10 1/8 (276)	6 1/4 (171)	9 5/8 (251)
8G24 FT	P	FEMALE 1/4"	N/A	335	470	132	33	57	140	245	500	845	204	152	119	100	78	48.5	35.0	19.77	12.6	10.75	8.30	6.8	3.68	3.12	1.68	0.845	84.5	73.6	68.0	64.5	63.0	59.3	48.5	52.0 (23.6)	10 1/4 (260)	6 3/4 (171)	8 3/4 (210)
8G24 UT	P	T881	N/A	335	470	132	33	57	140	245	500	845	204	152	119	100	78	48.5	35.0	19.77	12.6	10.75	8.30	6.8	3.68	3.12	1.68	0.845	84.5	73.6	68.0	64.5	63.0	59.3	48.5	52.0 (23.6)	10 1/4 (260)	6 3/4 (171)	9 5/8 (251)
8G27	HPQ	T872M	N/A	505	700	160	40	70	170	300	605	1000	255	195	150	125	95	57.0	41.5	23.3	14.4	12.67	9.80	8.03	4.32	3.67	1.99	0.99	99.5	86.4	80.3	76.0	72.0	69.9	57.0	63.2 (28.7)	12 1/4 (324)	6 3/4 (171)	9 5/8 (251)
8G31DT	HPT	SAE/Stud	N/A	550	780	180	51	84	190	335	690	1160	280	210	170	145	110	64.5	47.0	26.2	16.1	14.2	11.0	9.0	4.88	4.10	2.15	1.08	108.0	97.6	90.0	85.2	80.5	78.6	64.5	70.0 (31.8)	12 5/8 (329)	6 3/4 (171)	9 5/8 (238)
8GGC2	PV	T881	N/A	585	850	345	92	155	375	680	1360	2200	325	250	210	180	150	99.0	76.0	45.3	29.4	25.8	20.0	16.8	9	7.6	3.9	1.98	198.0	180.0	168.0	155.0	147.0	136.0	99.0	68.4 (31.0)	10 1/4 (260)	7 1/8 (181)	10 1/8 (276)
8G4D	HP	SAE	T903	970	1245	375	105	175	395	685	1385	2300	485	375	300	255	195	122.0	88.0	49.2	30.5	26.7	20.7	16.9	9.15	7.78	4.22	2.1	210.0	183.0	169.0	160.2	152.5	147.6	122.0	127.0 (57.6)	20 1/4 (527)	8 1/2 (216)	10 (254)
8G8D	HP	SAE	T903	1150	1470	475	135	220	500	890	1750	3000	600	460	370	315	245	150.0	105	60.6	37.6	33.0	25.5	21.0	11.25	9.54	5.18	2.65	265.0	225.0	210.0	198.0	188.0	181.8	150.0	157.0 (71.2)	20 1/4 (527)	11 (279)	10 (254)

## SOLAR APPLICATIONS

Specifications							Minutes Discharged @*						Discharge Amps to 1.75 VPC @ 77°F (25°C)*												Ampere Hour Capacity*						Weight	Dimensions - In (mm)							
Model	Foot Notes	Terminal Standard	Terminal Option	CCA @ 0° F	CA @ 32° F	Res.Capacity @ 80° F	75 Amps	50 Amps	25 Amps	15 Amps	8 Amps	5 Amps	5 Min	10 Min	15 Min	20 Min	30 Min	60 Min	90 Min	3 Hour	5 Hour	6 Hour	8 Hour	10 Hour	20 Hour	24 Hour	48 Hour	100 Hour	100 Hr Rate	20 Hr Rate	10 Hr Rate	6 Hr Rate	5 Hr Rate	3 Hr Rate	1 Hr Rate	Approx. Lbs. (Kgs.)	Length	Width	Total Height (Incl. Term.)
SU1 SLD G	P	T873	N/A	175	250	44	5	12	47	90	190	325	74.7	54.3	44.6	38.8	31.9	21.0	15.0	8.5	5.36	4.67	3.56	3.05	1.58	1.33	0.73	0.36	36.5	31.6	30.5	28.0	26.8	25.5	21.0	23.4 (10.6)	7 1/4 (197)	5 1/2 (130)	7 1/4 (184)
S22NF SLD G	PV	T881	N/A	210	300	77	13	27	82	157	330	557	120	86.7	69.1	60	47	31.8	23.2	13.3	8.64	7.65	5.74	4.75	2.55	2.15	1.16	0.58	58.2	50.9	47.5	45.9	43.2	39.9	31.8	37.0 (16.8)	9 3/8 (238)	5 1/2 (140)	9 1/4 (235)
S24 SLD G	P	T881	N/A	335	470	132	33	57	140	245	500	845	204	152	119	100	78	48.5	35.0	19.77	12.6	10.75	8.30	6.8	3.68	3.12	1.68	0.845	84.5	73.6	68.0	64.5	63.0	59.3	48.5	52.0 (23.6)	10 1/4 (260)	6 3/4 (171)	9 5/8 (251)
S27 SLD G	HP	T876	T881	400	550	160	40	70	170	300	605	1000	242.3	185.3	142.5	118.75	90.25	57.0	41.5	23.3	14.4	12.67	9.80	8.03	4.32	3.67	1.99	0.99	99.5	86.4	80.3	76.0	72.0	69.9	57.0	62.7 (28.4)	12 1/4 (324)	6 3/4 (171)	9 1/4 (235)
S31 SLD G	HP	T876	N/A	485	685	180	51	84	190	335	690	1160	266	199.5	161.5	137.75	104.5	64.5	47.0	26.2	16.1	14.2	11.0	9.0	4.88	4.10	2.15	1.08	108.0	97.6	90.0	85.2	80.5	78.6	64.5	69.5 (31.5)	12 5/8 (329)	6 3/4 (171)	9 5/8 (248)
S4D SLD G LTP	HP	T975	N/A	970	1245	375	105	175	395	685	1385	2300	485	375	300	255	195	122.0	88.0	49.2	30.5	26.7	20.7	16.9	9.15	7.78	4.22	2.1	210.0	183.0	169.0	160.2	152.5	147.6	122.0	127.0 (57.6)	20 1/4 (527)	8 1/2 (216)	10 5/8 (270)
S8D SLD G LTP	HP	T975	N/A	1150	1470	475	135	220	500	890	1750	3000	600	460	370	315	245	150.0	105	60.6	37.6	33.0	25.5	21.0	11.25	9.54	5.18	2.65	265.0	225.0	210.0	198.0	188.0	181.8	150.0	157.0 (71.2)	20 1/4 (527)	11 (279)	10 5/8 (270)
S6VGC SLD G	PV	T881	N/A	585	850	345	92	155	375	680	1360	2200	325	250	210	180	150	99.0	76.0	45.3	29.4	25.8	20.0	16.8	9	7.6	3.9	1.98	198.0	180.0	168.0	155.0	147.0	136.0	99.0	68.4 (31.0)	10 1/4 (260)	7 1/8 (181)	10 1/8 (276)

## CABLE APPLICATIONS

Specifications							Minutes Discharged @*						Discharge Amps to 1.75 VPC @ 77°F (25°C)*												Ampere Hour Capacity*						Weight	Dimensions - In (mm)							
Model	Foot Notes	Terminal Standard	Terminal Option	CCA @ 0° F	CA @ 32° F	Res.Capacity @ 80° F	75 Amps	50 Amps	25 Amps	15 Amps	8 Amps	5 Amps	5 Min	10 Min	15 Min	20 Min	30 Min	60 Min	90 Min	3 Hour	5 Hour	6 Hour	8 Hour	10 Hour	20 Hour	24 Hour	48 Hour	100 Hour	100 Hr Rate	20 Hr Rate	10 Hr Rate	6 Hr Rate	5 Hr Rate	3 Hr Rate	1 Hr Rate	Approx. Lbs. (Kgs.)	Length	Width	Total Height (Incl. Term.)
E27 SLD G	HP	T876	T881	400	550	160	40	70	170	300	605	1000	242.3	185.3	142.5	118.75	90.25	57.0	41.5	23.3	14.4	12.67	9.80	8.03	4.32	3.67	1.99	0.99	99.5	86.4	80.3	76.0	72.0	69.9	57.0	62.7 (28.4)	12 1/4 (324)	6 3/4 (171)	9 1/4 (235)
E31 SLD G	HP	T876	N/A	485	685	180	51	84	190	335	690	1160	266	199.5	161.5	137.75	104.5	64.5	47.0	26.2	16.1	14.2	11.0	9.0	4.88	4.10	2.15	1.08	108.0	97.6	90.0	85.2	80.5	78.6	64.5	69.5 (31.5)	12 5/8 (329)	6 3/4 (171)	9 5/8 (248)
E31 SLD G ST	HP	STUD	N/A	485	685	180	51	84	190	335	690	1160	266	199.5	161.5	137.75	104.5	64.5	47.0	26.2	16.1	14.2	11.0	9.0	4.88	4.10	2.15	1.08	108.0	97.6	90.0	85.2	80.5	78.6	64.5	69.5 (31.5)	12 5/8 (329)	6 3/4 (171)	9 5/8 (238)

\*Ampere hour capacity is a nominal rating. All ratings are after 15 cycles and conform to B.C.I. specifications.

### FOOTNOTES:

- H - Includes handles
- P - Polypropylene container and cover
- Q - Combination terminals, offset post with 5/16" stainless stud and wing nuts
- T - Dual top terminals w/SAE posts & stainless steel 3/8" stud and wing nuts
- V - Combination terminals, offset post with horizontal hole, 5/16" bolt and hex nut



*MK Sealed Gel Batteries:*

# THE STANDARD BY WHICH ALL OTHER BATTERIES ARE MEASURED.



## BENEFITS

- Completely maintenance free. Sealed construction eliminates periodic watering, corrosive acid fumes and spills.
- Electrolyte will not stratify, no equalization charging required. Allows faster recharge.
- Increases durability and deep cycle ability for heavy demand applications.
- Less than 2% per month stand loss means little deterioration during transport and storage.
- Tank formation ensures voltage matching between cells.
- Transports easily and safely by air.
- Quality construction ensures reliable service and support.

## APPLICATIONS

- Water Pumping
- Residential
- Communications
- Cathodic Protection
- Remote Monitoring
- Refrigeration
- Lighting
- Aids to Navigation
- Wind Generation
- Power Wheelchairs
- RV
- Golf Cart
- Solar
- Many Other Applications

## SPECIFICATIONS

Voltage	6 & 12 volts nominal
Plate Alloy	Lead calcium
Posts	Forged terminals & bushings
Container/Cover	Polypropylene
Charge Voltage @ 68°F (20°C)	Cycle 2.30 to 2.35; Float 2.25 to 2.30 v.p.c.
Specific Gravity	1.280
Electrolyte	Sulfuric acid thixotropic gel
Vent	Self-sealing (2 PSI operation)
Operating Temperature	Fully charged range: -76°F (-60°C) to 140°F (60°C)

# Charging Information

\*AMPERE HOUR CAPACITY IS A NOMINAL RATING.  
ALL RATINGS ARE AFTER 15 CYCLES AND CONFORM TO B.C.I. SPECIFICATIONS.

**BATTERY VOLTAGE:** All batteries are 12 Volt excluding MODEL 8GGC2, which is 6 Volt.

**IMPORTANT CHARGING INSTRUCTIONS:** WARRANTY VOID IF OPENED OR IMPROPERLY CHARGED. Constant under or overcharging will damage any battery and shorten its life! Use a good constant potential, voltage-regulated charger. **For 12-volt batteries, charge to at least 13.8 volts but no more than 14.1 volts at 68°F (20°C). For 6-volt batteries, charge to at least 6.9 volts but no more than 7.05 volts at 68°F (20°C).** Do not charge in a sealed container.

**NON-SPILLABLE** by DOT (Department of Transportation), ICAO (International Commercial Airline Organization), and IATA (International Airline Transport Association) definitions.

## TERMINAL INFORMATION

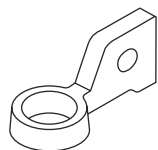

T876

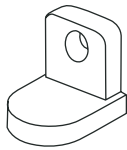

T873

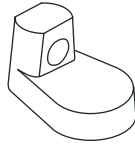

T881



SAE

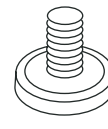

STUD

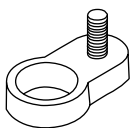

T903



T835



T975

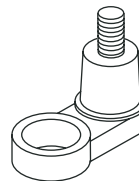

T872M

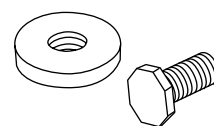

FEMALE 1/4"



UL Recognized Component  
MH17218

QUALITY SYSTEM  
CERTIFIED TO  
**ISO 9001**  
**ISO/TS 16949**

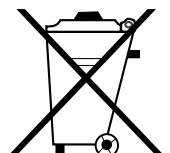

Pb

# CHARACTERISTICS OF MK GEL BATTERIES

**Gel Cycle Life vs Depth of Discharge at +25°C (77°F)  
Based on BCI 2-hour Capacity**

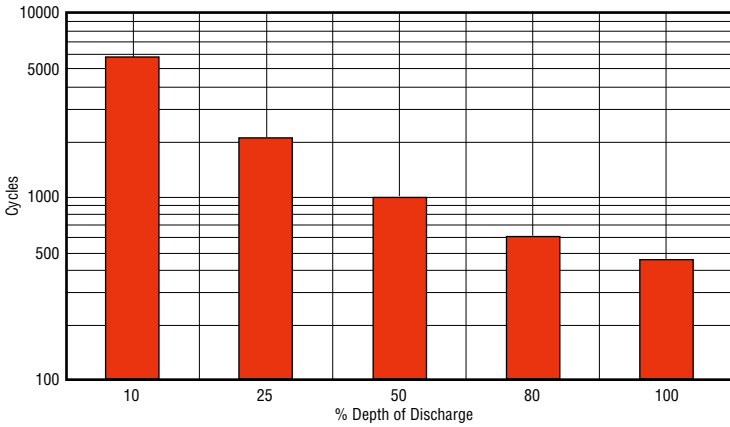

Cycle Chart applies to all MK Gel batteries (except 8GGC2 cycle chart x 2, 8G24/8G27 with a T872M terminal and 8G31DT cycle chart x .67).

**Self-Discharge of Gel Batteries  
at Different Temperatures**

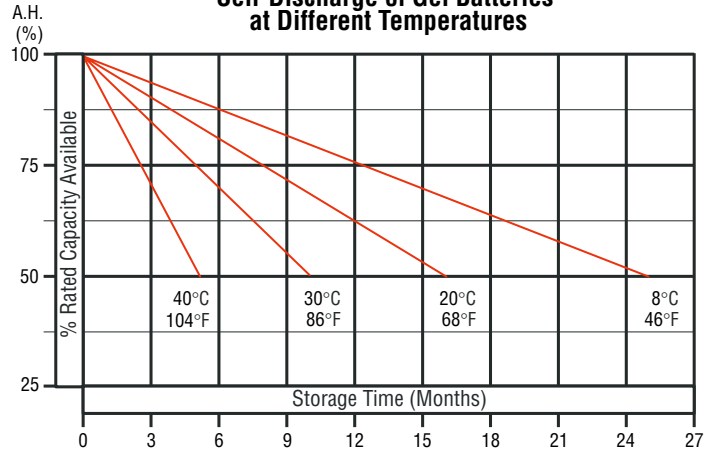

**Capacity vs Operating Temperature**

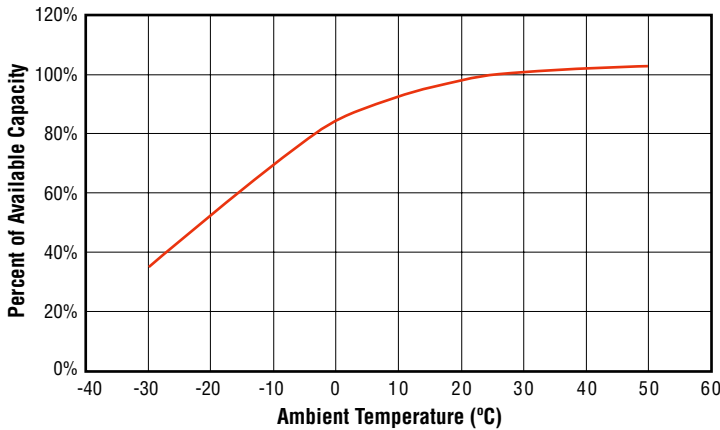

**Capacity vs Operating Temperatures**

Shown are the changes in capacity for wider ambient temperature range, giving the available capacity, as a percentage of the rated capacity, at different ambient temperatures.

**Constant Charging Voltage**

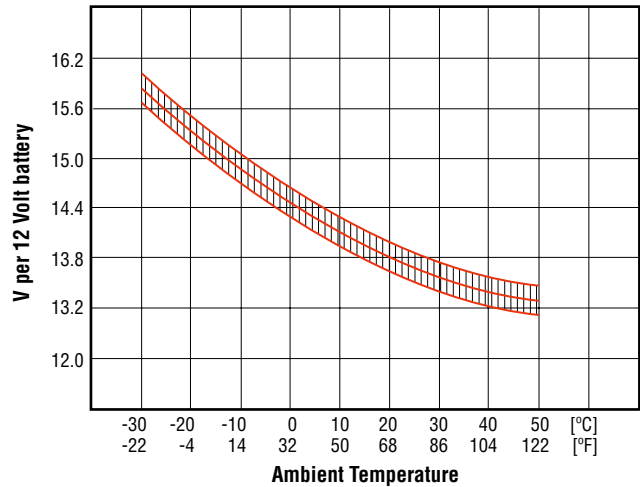

**Constant Charging Voltage**

Shown is the constant charging voltage in relation to the ambient temperature. The bandwidth shows a tolerance of  $\pm 30\text{mV/cell}$ . This constant voltage is suitable for continuous charging and cyclic operation. In a parallel stand-by mode it always keeps the battery in a fully charged state; in a cyclic mode, it provides for rapid recharging and high cyclic performance.

## YOUR PARTNER IN POWER

Products

Service

Customer Care

MK Battery is one of the largest sealed lead acid battery distributors worldwide due to our total commitment to the following core principles:

**Products:** MK Battery manufactures and distributes only the highest quality batteries (GEL, AGM and flooded deep cycle) that are specifically designed for our customers' many, varied applications including broadband communications, UPS (uninterruptible power supplies), power wheelchairs, telephony (valve-regulated stationary), solar, marine and electronics.

**Service:** MK Battery ships fresh inventory fast, often within 24 hours, from a stock of more than 100,000 batteries in multiple key warehouses throughout North America and assures our customers proper spent battery disposal through EPA permitted smelters. (Please note that violation of hazardous waste disposal laws place heavy penalties on offenders)

**Customer Care:** MK Battery is genuinely concerned for our customers' well-being as a long-term partner... not just a supplier. MK Battery listens to our customers and delivers what you want, when you need it.



MK Battery: 1645 South Sinclair Street • Anaheim, California 92806

Toll Free 800-372-9253 • Tel 714-937-1033 • Fax 714-937-0818 • Website: [www.mkbattery.com](http://www.mkbattery.com) • Email: [sales@mkbattery.com](mailto:sales@mkbattery.com)